

PRE DELIVERY INSPECTION MANUAL MG 4 EV

GENERAL NOTES

This pre-delivery inspection manual covers the MG 4 Electric , if the item is not fitted to the vehicle or is not applicable go to the next inspection or instruction.

Fit car protection kit to steering wheel, driver's seat and driver's foot well.

PRIOR TO COMMENCING WORK

1. **Check register of service action bulletins and carry out any outstanding actions.**

INITIAL PREPARATION

2. **Check all panels for correct profile, alignment and any fouling condition**
 - a. Visually inspect correct alignment of:
 - i. Doors
 - ii. Bonnet
 - iii. Tailgate
 - iv. Charging point door
 - v. Front and rear bumpers
 - vi. Wings
 - b. Visually check panels for correct profile.

3. Check paint and bodywork for damage

- a. Inspect paint and bodywork from a distance of 1 metre whilst walking around the vehicle.
- b. Refer to transit delivery note for recorded damage/missing items

4. Check all keys are supplied and operate systems correctly

- a. Test both door key handsets for lock, unlock and tailgate/boot release.

5. Connect vehicle to SIPS, set vehicle to Normal mode, clear all stored fault codes, check and record matching status of all modules for correct software and calibration levels.

- a. SIPS will automatically place the vehicle in Normal mode
- b. Clear all DTC fault codes.
- c. Check ECU information to examine the Matching Status of the ECU information against the manufacturer database information – record any mismatch details and consult MG Technical Support to check if any essential updates are necessary.

6. Connect vehicle to workshop HV charge point, check operation of charging system and lamps.

- a. Check operation of vehicle charge status lamp.
- b. Ensure vehicle charging system is fully functional and accepts charge monitoring the charging interface displayed in the IPK.
- c. Disconnect charging device for remainder of PDI.

INSIDE VEHICLE

7. Check for evidence of water ingress

- a. Check for evidence of water ingress in driver/ passenger front and rear foot wells and boot luggage space.

8. Check operation of storage compartments and sun visors, including illumination.

- a. Check operation of storage compartments.
 - i. Glove box
 - ii. Centre console cubby

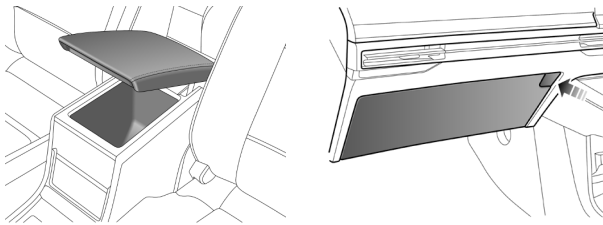

- b. Check operation of sun visors and slide covers

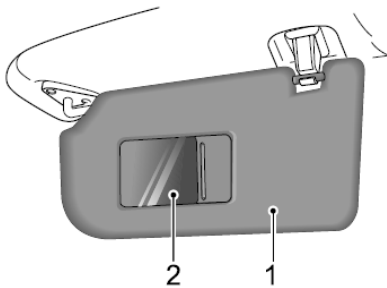

- c. Check storage compartment illumination (where applicable).

9. Check cables and wiring for security and correct installation.

- a. Ensure all accessible electrical connectors are securely fastened and the wiring correctly routed inside the car and loadspace. Pay particular attention to possible fouling conditions.

10. Check seat slide, reclining mechanism and head rest adjustment – manual and electric seats.

- a. Check seat slides, recline mechanism and height adjustment for correct operation and smooth movement along full length of travel.
- b. Seat must lock in all intermediate travel positions.
- c. Check rear folding seats for operation, security and latching.

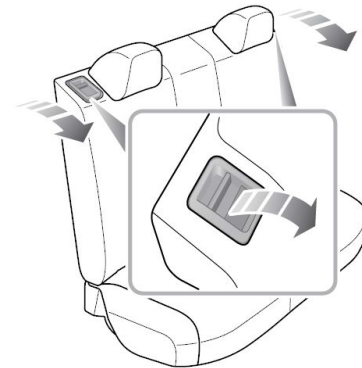

- d. Check headrest locking and release mechanism, ensure smooth operation and locking in all positions.

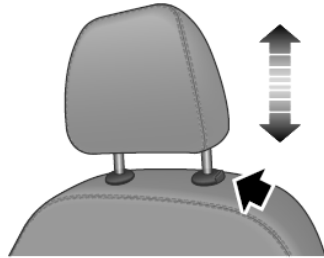

I I. Check seat belt, clasp and passenger detection device operation (front and rear)

- a. Fully extract seat belt and allow it to return under its own recoil mechanism.
- b. Connect each seat belt to correct buckle.

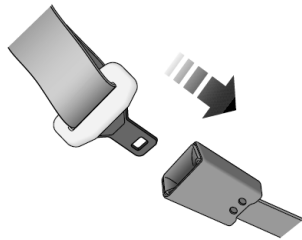

- c. Check each seat belt buckle and tongue are secure and release correctly.
- d. Use an assistant to occupy the passenger and rear seats, check for correct operation of the 'fasten seat belt' warning lamp.

I 2. Check operation of passenger airbag disable switch

Use passenger airbag disable switch to isolate passenger airbag.

- a. Use a suitable flat bladed device
- b. Check for correct warning display.

I 3. Check operation and alignment of windows, including one touch and anti trap.

- a. Check operation of electric window glasses:
 - i. Each glass must travel through its entire range smoothly and quietly
 - ii. Operate and check the one touch and inch mode function, ensure full travel of glass.
- iii. Operate and check anti trap function, ensure glass drops sufficiently if object detected on upward travel.

I 4. Check operation of door mirrors

- a. Check operation of electrically operated door mirrors.
- b. Check heating element operation (in conjunction with heated rear window)
- c. Operate mirror switch in LH and RH positions.
 - i. Check that mirror moves through all plains.
- d. Check mirror fold operation – manual and electric

15. Check operation of horn

- Press each side of horn button on steering wheel.
- Check that horn(s) operate correctly giving a loud clear blast.

16. Check front and rear screen wiper and washer operation (including rain sensor) and alignment of washer jets and wiper blades

- With ignition on, operate screen washers and ensure washer jets are correctly aimed.
- Operate wipers and check for smooth, smear free operation of wiper blades across screens at all speeds including intermittent wipe and Auto functions.
- Ensure wipers park correctly when switched off.
- Apply a small amount of water to the rain sensor and check operation of wipers.

17. Check operation of steering column adjustment and steering wheel controls.

- Check steering column for security.
- Check steering column.

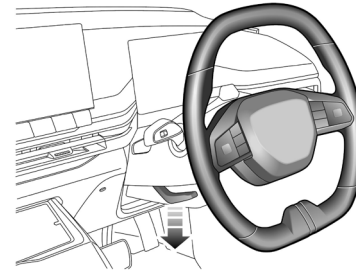

- Check operation of steering wheel switch and vehicle option controls.

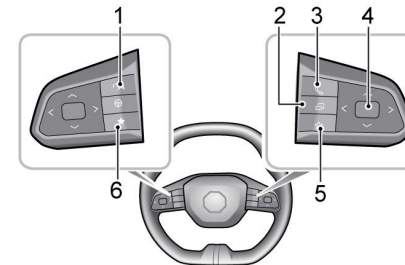

18. Check operation of In Car Entertainment (ICE), USB sockets and Navigation System. Check screen calibration and ensure clock is set to correct time.

- Check ICE for volume, tone, fader and balance operation (including steering wheel controls).
- Monitor sound from speakers for clarity and interference.

PRE DELIVERY INSPECTION MANUAL MG 4 EV

- c. Check clock displays correct time, ensure 'Automatic Time' is set to ON or manually set time (refer to owner's manual for operating instructions – ICE level dependent).
- d. Check navigation system for basic operation and map display.
- e. Check operation of available APP's.
- f. Check out screen calibration, only carry out if necessary – refer to owner's manual for details
- g. Check USB sockets for fitment, security and communication and charging capability.
- h. Check owners literature stored on FICM for correct version/s.

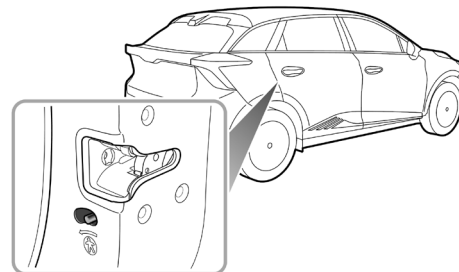

19. Register iSmart system (where applicable)

- a. Use the FICM to access 'Settings'
- b. Switch on the wireless function
- c. Link vehicle to local WIFI
- d. Select 'Activation'
- e. Activate the certificate
- f. Activate the maps

20. Check operation of master lock/unlock buttons, interior door release handles and child locks.

- a. Operate master lock/unlock buttons, ensure the doors lock and unlock when requested.
- b. Check all interior door handle functions.
- c. Check operation of rear door child lock

21. Check operation of interior illumination and timer delay

- a. Open doors
 - i. Ensure all interior lamps are illuminated
 - ii. Close doors
- b. Ensure all interior lamps extinguish
- c. Monitor delay time.

22. Check operation of instrument and switch illumination.

- a. Switch on side lights and check all switches and instruments are illuminated
 - i. Check operation of dimmer device.

23. Check heated rear screen operation.

- a. Ensure neutral or park is selected and handbrake applied.
- b. Start engine/READY mode.
- c. Check operation of heated rear screen (all bars)
 - i. Monitor any timer activation

- c. Position suitable beam setting equipment to the headlamp
- d. Switch on headlamps, and check alignment;
 - 1.0% - Vertical,
 - 0.0% - Horizontal
- i. Adjust accordingly

OUTSIDE VEHICLE

24. Check operation of all exterior lamps and headlamp alignment including:

- Side lamps – front and rear
 - Daytime running lamps
 - Dipped headlamps (Auto function where fitted)
 - Main beam headlamps
 - Number plate lamps
 - Indicators
 - Indicator side repeaters
 - Stop lamp (inc. CHMSL)
 - Reverse lamps
 - Rear fog lamps
- a. Operate the exterior lamp systems individually, check that all relevant warning lights are illuminated.
 - b. Inspect the individual lamps for:
 - i. Security
 - ii. Clarity
 - iii. Correct operation

25. Check operation of parking distance control and reverse camera (where fitted).

- a. Ensure vehicle is NOT in READY mode
- b. Select reverse gear.
- c. Request a colleague walks behind the vehicle, approaching the vehicle from a distance of 2 metres at various angles (considering all sensors).
- d. Monitor the parking distance control sounder for correct operation as described in the Technical Literature.
- e. Check reverse camera image on ICE display (where applicable).

26. Check operation of all keys, exterior locks, electronic releases and security system

- a. Operate each remote handset to lock and unlock doors and tailgate.
- b. Operate driver's door lock using the mechanical key blade.
- c. Check that door locks operate smoothly and positively
- d. Open each door/boot/bonnet with alarm armed.
- e. Check warning sounder operation.
- f. Check operation of electronic boot release.

27. Check operation of Keyless Entry System – both handsets

- a. Check operation of both front door handle lock/unlock buttons.
- b. Check door lock/unlock function with keys out of range – stand 2 metres away from the car and test the door handle lock/unlock buttons

28. Check charging plug door operation and alignment

- a. Operate charging plug door to release
 - i. Open and close
- b. Ensure charging plug grommet is correctly fitted.
- c. Check for correct alignment
- d. Check charging plug door locking device
- e. Check operation of charging plug emergency manual release
- f. Check operation of charging plug door manual release

29. Check for correct fitment of all aperture seals and flip seals

- a. Check all seals in door and tailgate apertures for correct fitment.

30. Check door, bonnet and tailgate closure loads

- a. Ensure all doors, bonnet and tailgate operate smoothly and positively – open and close several times.

31. Check and adjust tyre pressures. Check operation of tyre pressure monitoring pressure data display. Check tyre inflation and toolkit for presence and completion.

- a. Check and adjust tyre pressures.
- b. Refer to Technical Literature for correct pressures.
- c. Check display pressures in IPK information centre.
- d. Check for presence of, and complete contents of the tyre inflation and toolkit.

32. Check wheel nut torque.

- a. Check all wheel nuts are set to the correct torque.
- b. Refer to Technical Literature for the correct torque.

UNDER BONNET

Before starting work

Fit vehicle protection covers.

33. Check operation of bonnet primary and secondary catch

- a. Release bonnet using interior release lever and check that the mechanism operates freely and is correctly adjusted.
- b. Pull upwards on bonnet to check engagement of secondary catch.
- c. Release secondary catch, raise bonnet and locate support rod.
- d. Check that bonnet is safely supported when raised.

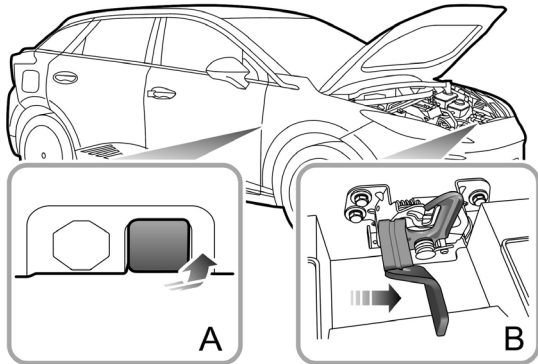

34. Lubricate and check security of 12V battery terminals

- Check security of 12V battery terminals.
- Lubricate battery terminals using petroleum jelly or other suitable material.
- Ensure that cover is correctly fitted over the battery/positive terminal.
- Ensure correct fitment of battery blanket.

35. Check 12V battery charge & record voltage (charge if necessary)

- Use suitable test equipment to examine voltage of the 12V battery – follow equipment instructions and record data.

36. Check/top-up brake and screen washer fluids

- Check and if necessary top-up brake fluid with the recommended fluid.

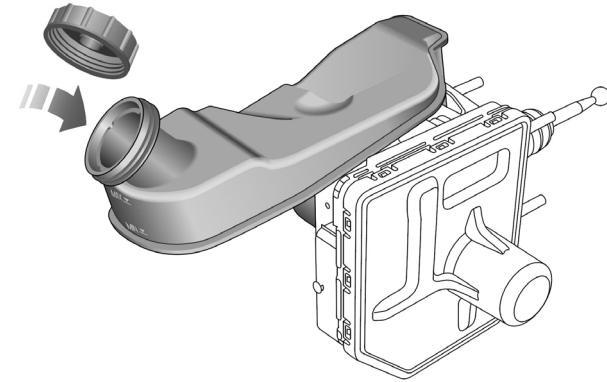

- Top-up screen washer reservoir, make sure top-up container is clean and free of debris.

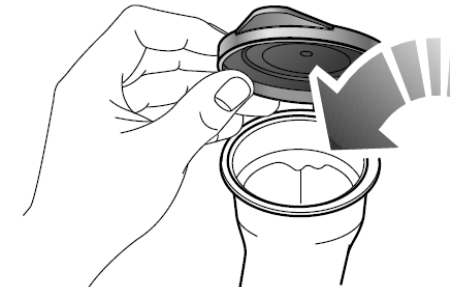

37. Check wiring harness and visible brake pipes for alignment and security – do not remove covers.

- a. Check wiring for routing, signs of chafing and security – adjust accordingly
- b. Check brake pipes. Ensure pipes and fixings are secure, correctly aligned and free from distortion. Look for signs of chafing, corrosion and leakage.

38. Check HV Battery and Motor/PEB system coolant levels – top up accordingly.

- a. Check and if necessary top-up cooling system expansion tanks using the recommended Anti-freeze in a 50/50 mix.

39. Visually check any coolant pipes for security

- a. Ensure hose clips are correctly positioned to secure hoses.
- b. Make sure all hoses are correctly routed and do not chafe against engine components or body.

40. Check all visible HV circuit connections for correct routing, fouling and security

- a. Where necessary wear protective equipment
- b. Ensure HV connectors are secure and fully latched in position
- c. Check wiring for routing, signs of chafing and security – adjust accordingly

UNDER CAR

41. Check wheels and tyres for signs of damage

- a. Check wheels for any signs of damage, inside, outside and wheel rims.
- b. Check tyres for any defects, damage or foreign objects.

42. Check HV battery for leaks and security

- a. Ensure all HV battery fixings are secure.
- b. Visibly check battery coolant hoses for security, correct routing and signs of leakage.
- c. Check HV battery earth strap for security.
- d. Ensure Master Safety Device (MSD) is fitted correctly.

43. Check all pipes, hoses, cables and wiring for correct routing

- a. Ensure all wiring, hoses, cables and pipes are routed correctly, secured with fixing clips.

44. Check brake pipes and unions for signs of leakage

- a. Ensure pipes and fixings are secure, correctly aligned and free from distortion.
- b. Look for signs of chafing, corrosion and leakage.

45. Check HV motor for signs of coolant leakage

- a. Ensure engine is clean and look for signs of oil or coolant leakage.

46. Check drive transmission for signs of leakage

- a. Ensure transmission is clean and look for signs of oil leakage.

PRE DELIVERY INSPECTION MANUAL MG 4 EV

47. Visually inspect all fixings for security.

- a. Carry out a visual inspection of all steering, suspension and powertrain fixings for correct fitment and security.

ROAD TEST

Prior to carrying out road test

Fit trade plates to vehicle.

48. Check instruments, message display and warning light operation/self check

- a. Switch on ignition,
- b. Check that all relevant warning lights are illuminated.
- c. System self check warning lights will extinguish approximately 3 seconds after the ignition is switched on.
- d. Plug driver's seat belt into clasp and ensure warning lamp extinguishes.
- e. Check for correct operation of all warning lights, speedometer, power meter and battery level gauges.

49. Check alignment of steering wheel

- a. Ensure steering wheel is correctly aligned when vehicle is driven straight ahead.
- b. Check indicators for correct lane change function operation.
- c. Check indicators for self-cancel;
 - i. Select RH and LH indicators.
- d. If steering wheel requires adjustment please see Workshop Manual.

50. Check operation of footbrake, parking brake and Hill Hold Control

- a. Apply/release the electronic parking brake, observe warning lamp operation.
- b. With parking brake applied ensure that vehicle is held firmly.
- c. When safe to do so check foot brake for pedal effort, travel and braking efficiency.
- d. Ensure that the braking is firm and responsive, and the brakes act smoothly and silently.
- e. Vehicle should come to rest without undue deviation.
- f. Bring vehicle to rest on a slope, check operation of Hill Hold Control.

51. Check motor and transmission operation in all gear selection and retardation positions

- a. Check for correct engagement and operation of Park (P) – ensure parking brake is activated by selecting P.
- b. Check for correct engagement of Reverse, Neutral and Drive (R, N, D)
- c. Check motor performance, noise level and accelerator pedal operation.
 - i. Ensure that the accelerator pedal movement is free and unrestricted and motor is responsive to accelerator movement.
- d. Ensure that the motor power is transmitted smoothly.
 - i. Listen for any noise that may indicate a fault.
- e. Ensure smooth operation during acceleration and deceleration (KERS) conditions in all drive and retardation modes:

- f. Check drive transmission performance at various speeds during acceleration and deceleration.
- g. Check for smooth and quiet operation at all speeds and for any abnormal transmission noises.

52. Check operation of Drive Assist Systems

- a. Check operation of front radar, camera and rear radar – due to the constraints of local conditions there is no set process for testing.

It is suggested that you carry out the following:

- b. Using the FICM 'Car Settings' switch ON the following:
 - i. MG Pilot
 - ii. Lane Departure Warning
 - iii. Speed Assist System
 - iv. Pedestrian Alert System
 - v. Front Collision System
 - vi. Rear Driving Assist
- c. Set the IPK to display the Driver Assist screen. Drive the car normally on a A or B class roads that features white marker lines at a speed above 35mph.
- d. Using the Adaptive Cruise Control stalk switch, activate:
 - i. Adaptive Cruise Control
 - ii. MG Pilot
- e. Check IPK information message centre images. Ensure the warning lights change from amber to green.
- f. Whilst driving the car ensure the road line markers illuminate white or blue.

- g. Where possible allow a car to overtake, monitor the mirror for blindspot warning OR allow a car to 'cross' the rear of the vehicle to check rear radar operation.

53. Check steering and suspension for noise and irregularities

- a. When in ready mode, turn steering wheel lock to lock, to check operation of power steering.
- b. Ensure the vehicle does not deviate from chosen direction.
- c. Ensure steering moves smoothly and easily and self-centres after cornering.
- d. Check suspension for:
 - i. Noise,
 - ii. Irregularity in ride
 - iii. Wheel imbalance
- e. The suspension should operate without undue noise and the ride should be characteristic of the model.

54. Check operation of heater, air conditioning and electric seat heaters

- a. Check that heater motor operates at all specified speeds and hot and cold air is distributed when the controls are operated.
- b. Operate air conditioning and close all external air vents and windows to validate satisfactory operation of the air conditioning.
- c. Switch on the electric seat heaters and ensure the correct operation of the heating elements.

55. Check for squeaks, rattles and excessive wind noise.

- a. Listen for any abnormal noises.
- b. Check for excessive wind noise, rattles from fascia or doors and exhaust system fouling on the body.

POST ROAD TEST - UNDER CAR

56. Check cooling systems for leaks and damage

- a. Ensure pipes, hoses and fixings are secure, correctly aligned and free from distortion. Look for signs of chafing, corrosion and leakage.

57. Re-check brake pipe unions for signs of leakage

- a. Ensure pipes and fixings are secure, correctly aligned and free from distortion. Look for signs of chafing, corrosion and leakage.

58. Re-check for leaks from motor and drive transmission

- a. Ensure there are no signs of leakage from the motor or transmission.

59. Check operation of cooling fan/s

- a. Connect SIPS and use the Actuator Test function to drive operation of cooling fans.
- b. Ensure fans operate and cut out.

FINAL PREPARATION

60. Carry out final PDI configuration using MG VDS.

- a. Check for recurring faults

61. Ensure that correct literature is contained within the owners information pack (If applicable)

- a. Quick guide
- b. Breakdown / recovery card

62. Remove any transit protection

- a. Remove plastic film from switches / tread plates, exterior trim, fusebox and lamps (where applicable)

63. Ensure interior trim and carpets are fitted correctly, clean and free from defects.

- a. Inspect trim for visual defects.
- b. Ensure trim and carpets fit neatly and correctly – fit any carpet mats supplied.
- c. Clean interior using suitable cleaning materials.

64. Clean exterior bodywork and trim.

- a. Wash the car using cold or lukewarm water containing a good quality wash and wax shampoo. Use plenty of water to ensure that grit is flushed from the surface and not ground into the paintwork.
- b. Rinse the bodywork with clean water and dry off with a chamois leather.
- c. Ensure the highest possible presentation and cleanliness.

65. Endorse service portfolio and PDI sheet and file copies with customer records

66. Connect vehicle to suitable charging device to ensure battery equalization has been achieved.

- a. Connect vehicle to low rate charging device (7kW max)
- b. Leave vehicle for suitable charging time to achieve 100% battery charge – this will allow the vehicle to complete the battery equalization process.